

BOSTITCH®

F28WW

PNEUMATIC STICK NAILERS

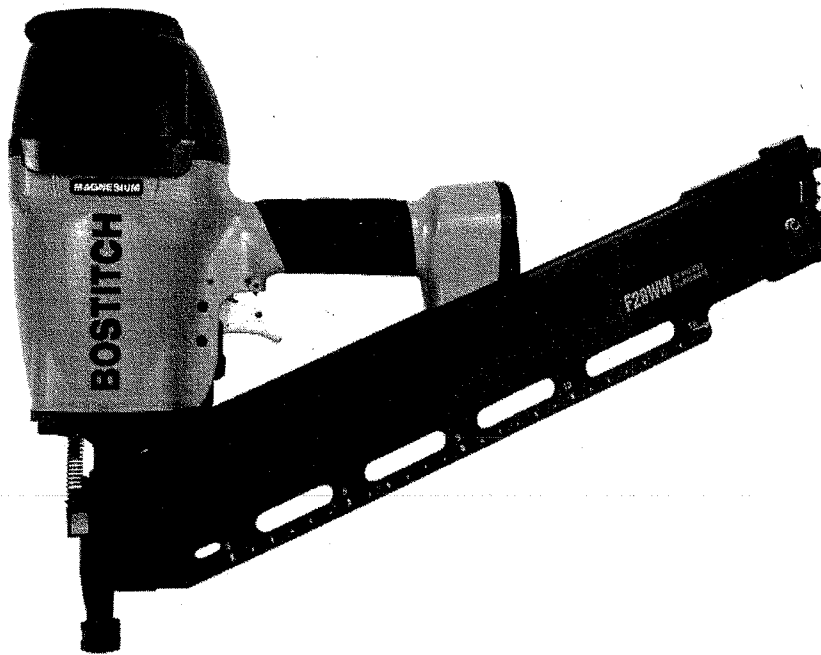

TOOL PARTS ILLUSTRATION

▲WARNING:

BEFORE PERFORMING REPAIRS ON THIS TOOL, ALL OPERATORS SHOULD STUDY THIS ILLUSTRATION, AS WELL AS THE PARTS LIST AND OPERATION AND MAINTENANCE MANUAL. OPERATORS SHOULD UNDERSTAND AND FOLLOW ALL SAFETY WARNINGS AND INSTRUCTIONS. KEEP THIS ILLUSTRATION WITH THE TOOL FOR FUTURE REFERENCE. IF YOU HAVE ANY QUESTIONS, CONTACT YOUR BOSTITCH REPRESENTATIVE OR DISTRIBUTOR.

F28WW

PNEUMATIC STICK NAILERS

See reverse side for available accessories (not included)

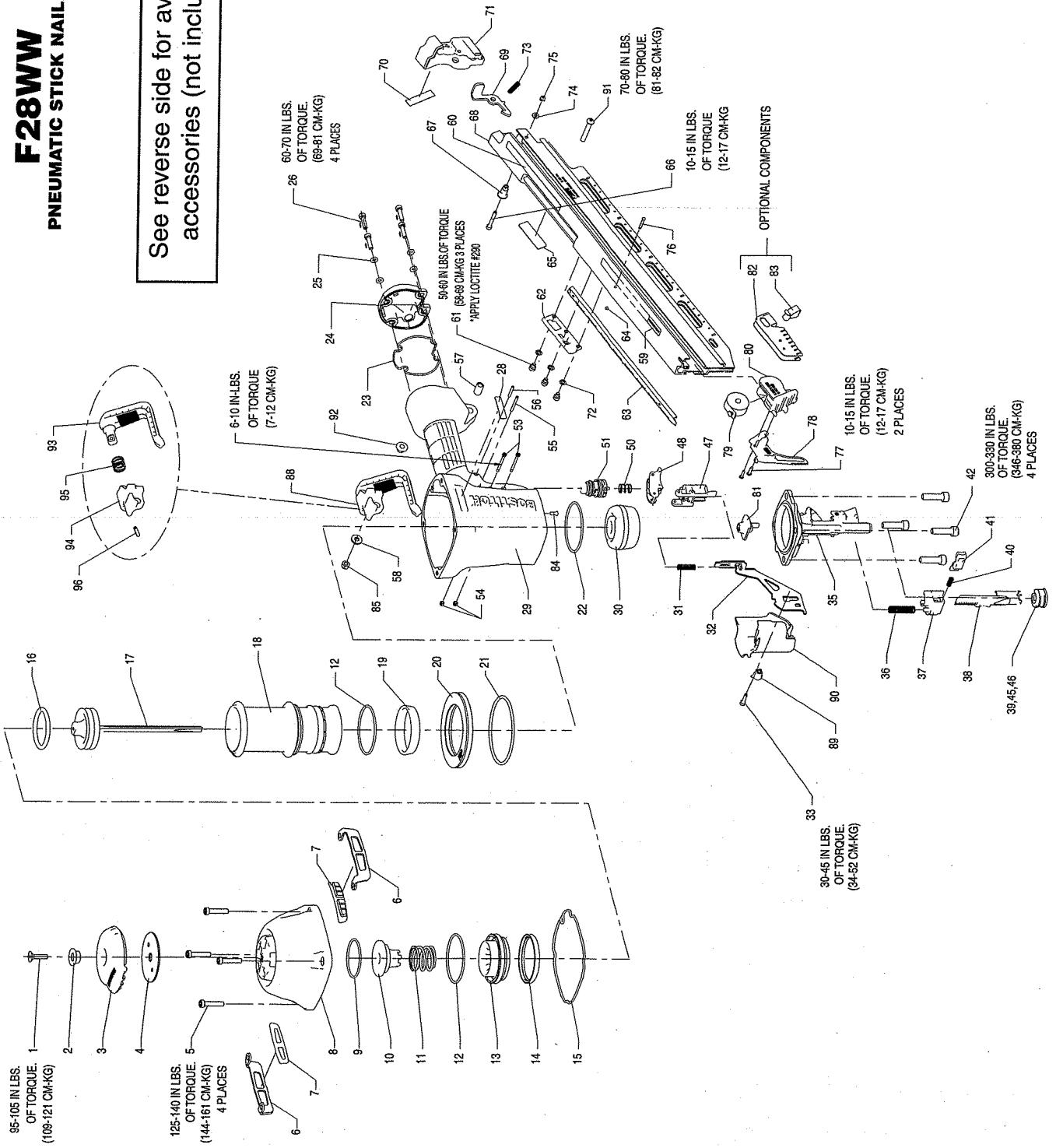

BOSTITCH

F28WW

Parts List: IP1211-2REVK

**To be Used with tool parts illustration: IP1211-1REVF
and operation and maintenance manual: 166762**

Serial Number on the Tool: F28WW 7171 000 and Higher

ITEM	PART #	DESCRIPTION	ITEM	PART #	DESCRIPTION
1	MSF6100-25	SCREW,SFHCS,M6X1.00X25	59	158612	LABEL,WARNING
2	163859	BUSHING,EXHAUST DEFLECTOR	60	112769	LABEL,N88WW FASTENER SPEC.
3	163818	DEFLECTOR,EXHAUST	61	MSC5080-6	SCREW,SHCS,M5X0.80X6
4	163830	PLATE,CAP	62	163828	NUT,TEE
5	MSC6100-30	SCREW,SHCS,M6X1.00X30	63	159718	LINER,NAIL GUIDE,N88WWB
6	163827	PLATE,WEAR	64	166797	O-RING,.056X.060 NBR
7	149819	WEAR GUIDE	65	104981	LABEL,WARNING
8	163848	FRAME CAP,MACHINING	66	100261	SCREW,SHCS,M4X30
9	105814	O-RING,1.929X.098	67	121472	SPACER,PUSHER LATCH
10	163820	BUMPER,HEAD VALVE	68	166784	MAGAZINE,PAD PRINT,F28WW
11	163844	SPRING,HEAD VALVE	69	166778	LATCH,PUSHER
12	163822	O-RING,2.487X.103XNBR	70	120927	LABEL,SENSOR SMALL (DR)
13	163821	LOWER BODY,HEAD VALVE	71	116563	CAP END,MAGAZINE
14	163823	SEAL,HEAD VALVE	72	116965	WASHER,PLAIN M5
15	163845	SEAL,FRAME/CAP	73	120878	SPRING, PUSHER LATCH
16	851606	O-RING,1.850X.210	74	MPW4	WASHER,PWN,M4
17	163922	ASSEMBLY,PISTON/DRIVER	75	MHE4070-100	ELASTIC STOP NUT,M4
18	163824	SLEEVE,CYLINDER	76	121407	PIN,SPECIAL
19	175520	SEAL,CHECK	77	100209	SCREW,STRHS,M3X0.5X12
20	163855	RING,CYLINDER SLEEVE	78	158767	PUSHER,WW
21	108718	O-RING,3.484X.139	79	115143	SPRING,CONSTANT FORCE
22	89673	O-RING,2.550X.103	80	120945	HANDLE,PUSHER
23	163856	SEAL,END CAP	81	163882	GUIDE,DRIVER
24	163843	END CAP,PAINT	82	112630	SHIELD,DUST
25	T50118	WASHER,PLAIN	83	112631	SPRING,CLIP
26	MSC5080-20	SCREW,SOC HD. CAP M5 X 20	84	163858	PLUG,EXHAUST
28	171432	LABEL,MAGNESIUM	85	MHE6100-100	NUT,ESN M6X1
29	171127	FRAME,OVERMOLD	88	171354	ASSEMBLY,UTILITY HOOK
30	107231	BUMPER,DRIVE	89	163903	BUSHING,TRIP COVER
31	166781	SPRING,UPPER TRIP	90	171338	COVER,TRIP
32	163899	ARM,UPPER CONTACT	91	MSB6100-40	SCREW,SBHCS,M6X1.00X40
33	MSC4070-16	SCREW,SHCS,M4X0.7X16	92	171342	WASHER,UTILITY HOOK
35	163927	NOSE,F28WW	93	171339	HOOK,UTILITY
36	166772	SPRING,CONTACT ARM	94	171340	MOUNT,UTILITY HOOK
37	108224	CASTING,HOUSING CONTACT	95	171341	SPRING,UTILITY HOOK
38	108227	ARM,LOWER CONTACT	96	UB3811.2	PIN, SPIROL - 5/32X3/4
39	121072	ASSEMBLY,TRIP FOOT			
40	115230	SPRING,HOUSING			
41	166777	CASTING,PLUNGER			
42	MSC8125-30	SCREW,SHCS M8X30			
45	121070	FOOT,TRIP			
46	121071	CLIP,TRIP FOOT			
47	163883	GUIDE,ARM			
48	SEQ7	KIT,SEQUENTIAL TRIP CONVERSION			
50	100387	SPRING,COMPRESSION			
51	TVA6	KIT,TRIGGER VALVE			
53	108562	SCREW,TRIGGER PIVOT			
54	MHE3050-100	NUT,NYLON M3X.50			
55	100298	PIN,SPIRAL M3X30			
56	MPP030020	PIN,SPIRAL M3X20MM			
57	N70143	BUSHING,RUBBER			
58	MPW6.2	WASHER,SPECIAL			